

Electric Drum & Tote Pumps

Pump Model • DM-55ODPS115, 115 volt

Pump Model • DM-55ODPS220, 220 volt



Benefits, Specifications, Parts Views & Codes

Drum Pump Operation

This electric, variable speed, drum pump drive is designed to interchange with the "DP" Series of drum pump tubes (tubes sold separately), available in CPVC, Polypropylene, Kynar, Aluminum or Stainless Steel. It includes an On-Off and speed control switch for safer handling, with thermally protected, manual overload reset and drop-in cartridge brush system. Recommended Components: DM-55BA/PP-SS tube safety adapter; DM-55PWB, wall bracket for safe storage; DM-55MRT Rinse Tube for fast, efficient cleaning.

Pump Tubes (sold separately)

The pump tube Materials of Construction are PVC, Polypropylene, Kynar (PVDF) Aluminum or Stainless Steel (316SS). Select the most suitable pump tube for your application(s) considering, 1) Chemical compatibility with the fluids being pumped, 2) Material thickness, 3) Liquid volatility. A "High-Head" version of these pump tubes is available, increasing both the head (height) pumping and thickness capacity of the pump.

Applications & Examples of Liquids Pumped

A light, easily handled, high performance pump for most types of thin-bodied, slightly viscous, aggressive and non-flammable liquids. Chemicals, cleaners, concentrates, corrosives and many liquid compounds compatible with the MOC's listed above.

Operating Specifications

Electrics: 115V-60Hz, or 220V-50Hz
 Flow rate: up to 29 - 38 Gpm
 Delivery head: 35 ft., (HH [Hi-Head] >75 ft)
 Temp. range: up to 132° F
 Pump Tubes: Sold Separately
 Dry-run cycle: 5 minutes, maximum

Power: 825 watt, (1.1 Hp) Open drip-proof drive
 Viscosity range: <750 Cps, (HH -1500 Cps (centipoise)
 Material density: Specific gravity, 1.8
 Pump Weight: 12 - 17 lbs. depending on components
 Pump Tube Sizes: 27" (pails), 39" (drums), 45" (IBCs), 60" (tanks)
Warning: For Non-flammable Use Only

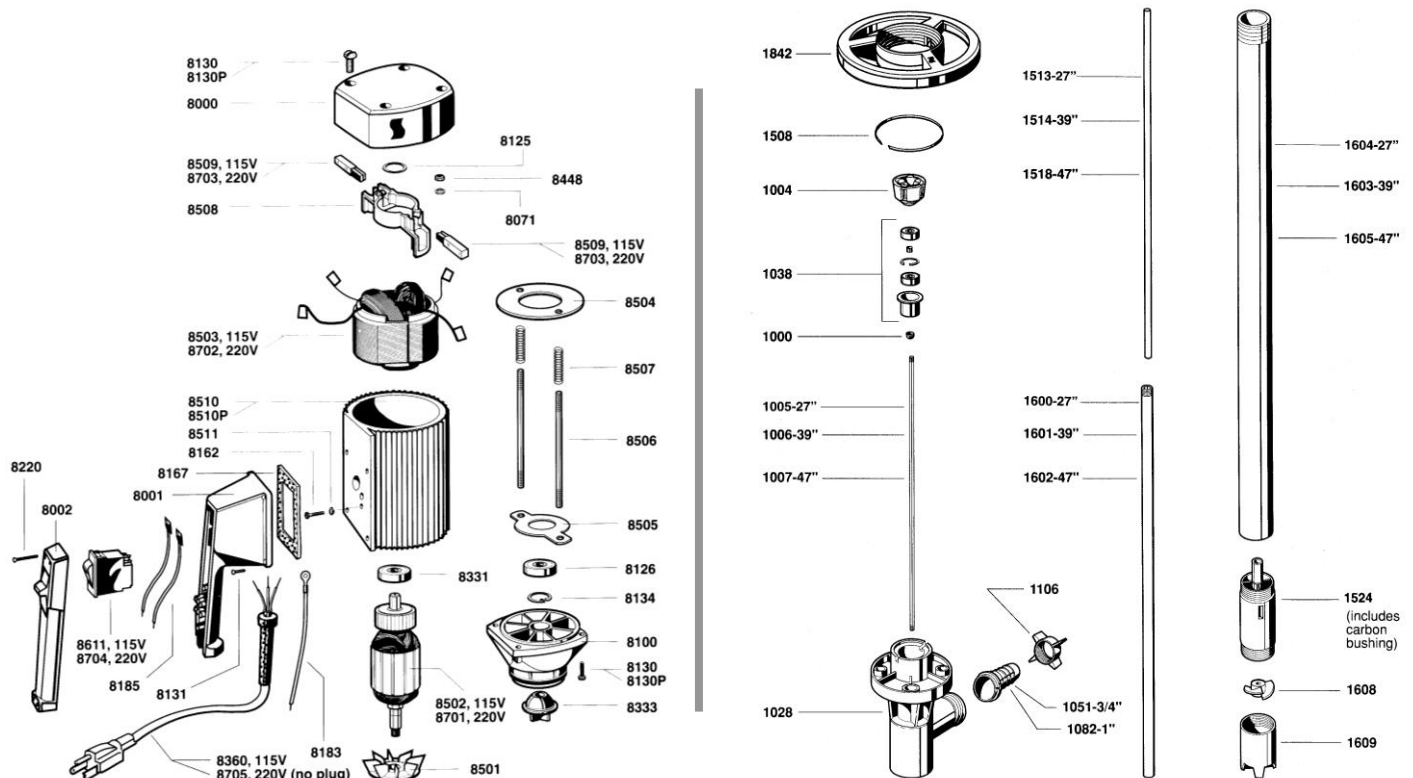

DM-55ODPS115/220 Drum Pump Drive

CPVC, Polypropylene, Kynar, Stainless Steel, AL Pump Tubes

Parts List • DM-ODPS110 or 220 Pump Drive

The DM-55ODPS pump drive is for use in nonflammable operations and areas only. Made in USA.

825 WATTS, 1 PHASE, 50 or 60 CYCLE

Part Number, 110 VAC

Description

8000	Motor cover
8001	Switch housing
8002	Switch cover
8071	Lock washer
8100	Lower housing
8125	Wave washer
8126	Ball bearing
8130	Screw
8130P	Screw for plastic housing
8131	Screw
8134	Snap ring
8162	Ground screw
8167	Gasket
8183	Earthing lead
8185	Lead
8220	Screw
8331	Ball bearing
8333	Motor coupling
8360	Power cord w/strain relief, 115V
8448	Hexagon nut
8502	Armature, 115V
8503	Stator, 115V
8504	Guide disc
8506	Rod connector
8507	Pressure spring
8508	Brush holder
8509	Carbon brush, 115V
8510	Motor housing
8511	Star washer
8512	Fan
8611	Overload switch, 8.5 amp, 115V

Part Number, 220VAC, IP-44 enclosure

8167LVR	Gasket, low voltage release
8701	Armature, 220V, open
8702	Stator, 220V, open
8703	Carbon brush, 220V
8704LVR	Overload switch, 5 amp, 220V, low voltage release
8705	Power cord, 220V, no plug

Recommended Safety & Service Components:

DM-55PWB, Pump wall safety storage bracket
 DM-55DP0150/SK, pump service kit with brushes, impellers, bearings, couplings, etc.
 DM-55MRT, Pump tube Rinse & Storage tube, AL or PVC
 Hand Dispensing Nozzles (see below)



DM-800HFR/L6 Series Nozzles
316 Stainless steel & Teflon



Ask for literature on DRUM-MATES® drum/tote mixers, drum tumblers, drum/tote pumps & hand nozzles.
 DRUM-MATES® Inc., Process Equipment Div., T: 609-261-1033, E: info@drummates.com, F: 609-261-1034