

# Drum Mixer Drives, Hi-Efficiency, 2" Bung Mount

## DM-BAS Series Drives, ¾ Hp to 1.5 Hp Pneumatic 2" Npt Bung Mount Mixer Drives

### Benefits

- Blend most liquids in industrial containers with 2" bungs
- Thoroughly & quickly mix with built-in variable speed
- Versatile - handles huge range of liquids & viscosities
- Excellent safety with fume and splash containment cap
- Bung mount drive easily transfers between containers
- Optional Stainless Steel or Teflon mixers sold separately

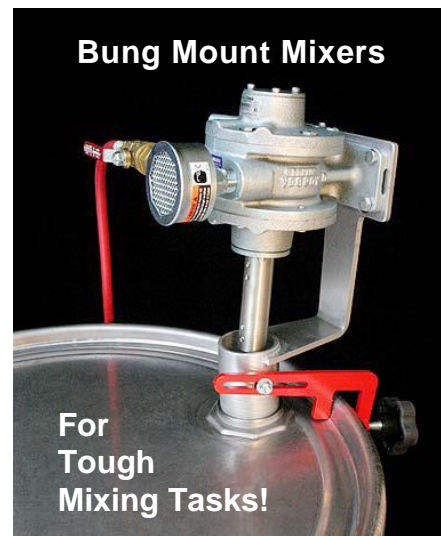

### General Description

The DRUM-MATES **DM-55BAS Series** high efficiency, heavy duty, 2" bung mount pneumatic mixers are versatile over a wide range of liquid mixing applications. These mixers fit any container with a 2" NPT bung including: 5, 15, 30, 55 to 500 gallon containers with a choice of ¾ Hp or 1.5 Hp drives with built-in variable speed. The motor is angled 3 degrees toward the center of a drum or container for best mixing agitation. Mixer side-wall drum contact at this angle is not possible, when properly mounted.

A complete mixer assembly (weighing less than 20 lbs.) easily transfers from drum-to-drum in seconds. The mount stand opening can be covered with the DM-55SCC/BAS cap to contain splashing and fumes and prevent airborne moisture or particulate contamination entry while mixing.

Drive Includes: Heavy-duty bracket, Stabilizer Arm, Rpm Control, Exhaust Muffler, Shaft Coupler. Mixer shaft with impellers is sold separately. A Filter-Regulator-Lubricator is required for best mixer maintenance, drive longevity & Warranty Compliance.

### Drive & Mixer Task Examples

Liquid Thickness Viscosity Range	Mixer Air Drives Product Codes	Air Drive Compressed Air Usage	IBC Mixer Shafts Product Codes	Mixer Blades Tiers & Sizes*
Water-like liquids	DM-45BAS/12, .75 Hp.	5-30 Cfm, 20-100 Psi	DM-55SSM/2	1-2 tiers, 6"
Thin to Heavy	DM-55BAS/12, 1.5 Hp.	5-75 Cfm, 20-100 Psi	DM-55SSM	1-4 tiers, 6"

### Optional Accessories

- DM-166GWK, Explosion-proof Grounding Cable Kit
- DM-55MRT-AL, Mixer Rinse & Storage Tube
- DM-55FRL, Filter-regulator-lubricator (for Warranty compliance)
- DM-55MHB, Mixer HoistHanger™ bracket, zinc plated steel
- DM-55SCC/BAS, Splash, Moisture & Fume Prevention Cap
- DM-55MMA-FF, Muffler Felt Filter Replacement Element



**DRUM-MATES, Inc.**

Email: [info@drummates.com](mailto:info@drummates.com)

Tel: 609-261-1033, Fax: 609-261-1034

# DM-45 BAS and 55BAS Series Mixer Air Drives

## Motor Information, Exploded View, Parts & Accessories

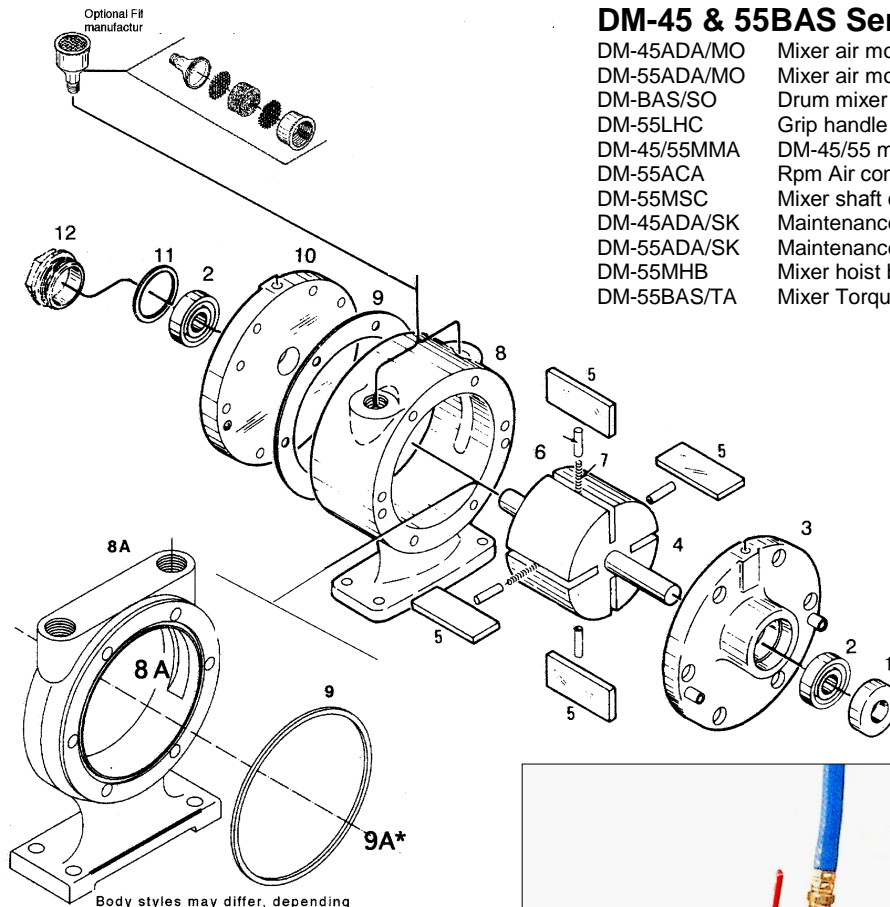

### DM-45 & 55BAS Series Parts & Accessories List

- DM-45ADA/MO Mixer air motor only, with exhaust, .75 Hp
- DM-55ADA/MO Mixer air motor only, with exhaust, 1.5 Hp
- DM-BAS/SO Drum mixer bung stand only, 2" Npt
- DM-55LHC Grip handle for BAS/RAS Series with fasteners
- DM-45/55MMA DM-45/55 metal muffler assembly with felt filter
- DM-55ACA Rpm Air control valve assembly, 1/4" Npt, brass
- DM-55MSC Mixer shaft coupler, 1/2" - 1/2" with Allen wrench, SS
- DM-45ADA/SK Maintenance or repair air motor service kit, .75 Hp
- DM-55ADA/SK Maintenance or repair air motor service kit, 1.5 Hp
- DM-55MHB Mixer hoist bracket with fasteners
- DM-55BAS/TA Mixer Torque Arm assembly, (clamp & fasteners)

Ref No	Description	Qty	4AM-FRV-13C	4AM-NRV-
1	Shaft Seal	1	AC466B	AA46
2	Dead End Bearing	1	AA299J	AA29
2	Drive End Bearing	1	AA299J	AA29
3	Drive End Plate	1	AC727	AC6
4	Rotor Assembly	1	AB617	AB6
5	Vane	4 8	AB876	AB8
6	Push Pins	4 8	AM467	AM4
7	Vane Spring	2 4	AM466	AM4
8	Body	1	AM425	AM4
9	Shims	2	B330	B33
10	Dead End Plate	1	AC728	AC7
11	End Cap Gasket	1	AA46	AA4
12	Dead End Cap	1	AM307D	AM30
13	Muffler Assembly	1	AL445	AL4
14	Muffler Cartridge	1	AL458	AL4
	Muffler Felt (for use with the AC980 Muffler Assembly)	1	AC983	AC9
	Service Kit	1	K205	K20

